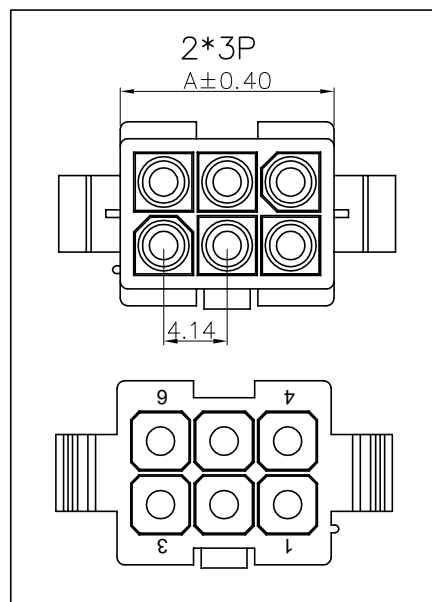
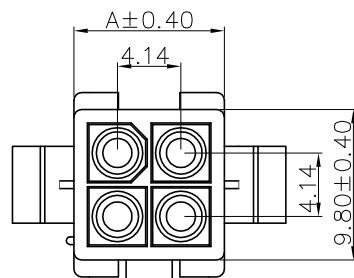

The product using material and processing must conform to the "WI-PZ-001"HSF technical standard control requirements

(RoHS)

 $2 \times 2P$ 

NOTE:

- 1.MATERIAL SPECIFICATION:
  - 1-1.HOUSING: PA66
- 2.ELECTRICAL PERFORMANCE:
  - 2-1.CURRENT RATING: 7A  
RATED VOLTAGE : 600V
  - 2-2.CONTACT RESISTANCE: 20 mΩ MAX
  - 2-3.INSULATION RESISTANCE: 1000MΩ Min
  - 2-4.DIELECTRIC WITHSTANDING : 1500V AC
- 3.ENVIRONMENTAL PERFORMANCE:
  - 3-1.OPERATING TEMPERATURE: -25°C~+85°C.
- 4.PACKAGE SPEGPE BAG
- 5.P/N:

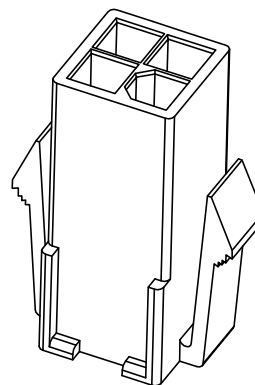
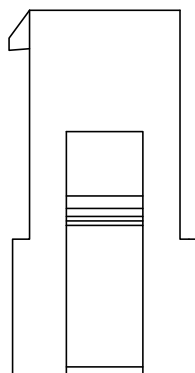
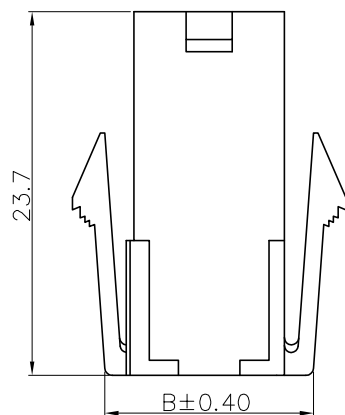

S.P.N.:

	C4140	H	F-2	XX	X	X	
SERIES NO:							HOUSING:
CONNECTOR:							0-UL94V-0
H-HOUSING							
MALE FEMALE:							COLOR:
M-MALE							A-BLACK
F-FEMALE							S-NATURE
ROW NO:							PIN Q'PY:
2-DOUBLE ROW							04~06

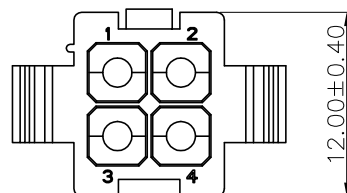

Circuit	A	B
2*02	9.80	13.59
2*03	13.94	17.73

REV.	REVISION RECORD	DATE		GENERAL TOLERANCES		SCALE: 1:1	NAME	DATE	PART.NO: C4140HF-2XXXX	DWG.NO: ENDE05	 WanLian Technology Co., Ltd
AO	NEW RELEASE	21.11.17		LINEAR	ANGLES	APPROVED	Wang_jr	21.11.17			
				0.0±0.35	X'REF±6°						
			UNIT: mm	0.00±0.25	X*±3°	DESIGNER	Han_Gao	21.11.17	TITLE: Pitch 4.14mm Female 双排 Housing		
				SIZE: A4	0.000±0.10	X*X' ±2°	DRAWN	Zijun_Huang		21.11.17	
										REV: AO	SHEET: 1/1